



Nearer to Nature Schools



Department of Biodiversity,
Conservation and Attractions

Perth Hills Discovery Centre

Essential information for your visit

Contents

Background	2
External Provider Checklist (Department of Education) Nearer to Nature program and venue information for excursion planning in order of DOE's Provider checklist.	2 - 24
Quick reference for items embedded in this document:	
Contacts	9 -10
Emergency procedures for Perth Hills Discovery Centre: * Risk Action Plan * Emergency Evacuation Plan and map	9 – 22
Insurance: certificates of currency	7 - 8
Program: Nearer to Nature	3
Staff: Nearer to Nature staff and volunteers • Working With Children Check • Duty of Care	2 - 4
Venue: Perth Hills Discovery Centre • Site maps • Accessibility • Risk management plan • Emergency evacuation plan • Muster points	22 - 24



Nearer to Nature

Background

The Department of Education requires the following information from Department of Biodiversity, Conservation and Attractions (DBCA) as an external provider, prior to schools engaging our services. The Department of Biodiversity, Conservation and Attractions works with the community to ensure that Western Australia's environment is valued, protected and conserved. We promote biodiversity and conservation and enrich people's lives through sustainable management of Western Australia's species, ecosystems, land and the attractions in our care. Department of Biodiversity, Conservation and Attractions (the department) implements visitor risk management (VRM) procedures and practices through a comprehensive and integrated program.

This document contains essential information for your visit, to assist you in completing your [External Provider Checklist](#) when planning your excursion, camp or activity at Perth Hills Discovery Centre (PHDC) and the surrounding Beelu National Park, through DBCA's Nearer to Nature program.

External Provider Checklist

To complete your Department of Education (DOE) **Appendix D: External Provider Checklist Nearer to Nature (N2N)** has provided the following information below, in order of the items as they appear on the checklist. Each point from DOE's checklist is shown in blue below, followed by the information you need from us as an external provider.

- **Proof of external provider's level of experience. This can be verified with copies of logbooks or a statement from the approved manager testifying to the competencies of its employees and/or copies of current qualifications**

➤ **Assessing capabilities and involvement of Nearer to Nature Leaders**

Nearer to Nature education leaders have been trained for, and have experience in, leading activities in the natural environment. Many of our leaders are former or practising teachers with science or education backgrounds. Leaders are trained in the Nearer to Nature programs and mentored by our Schools Coordinators who have classroom teaching experience.



Nearer to Nature

Leaders take part in quarterly team training in emergency response procedures, professional learning in areas of teaching and presenting, educational developments and learn from experts in the field in their relevant teaching areas. All of these strategies ensure that our team have excellent leading abilities and knowledge in the areas they teach.

Our leaders:

- hold a current Working With Children Check (WWCC), and
- are trained in first aid and hold current St John's Senior First Aid Certificates

Nearer to Nature program

Nearer to Nature is an education program provided by Parks and Wildlife Service within the Department of Biodiversity, Conservation and Attractions. Nearer to Nature run various excursions at a variety of locations including Perth Hills Discovery Centre.

Nearer to Nature provides the community with unique, enjoyable activities that help participants discover natural areas in and around Perth and the south-west. Specially designed activities with curriculum links are offered for schools.

Perth Hills Discovery Centre is a purpose-built educational facility in the jarrah forest with a network of trails in the Beelu National Park that allow school groups to explore various aspects of the forest ecosystem.

Note: Some areas of Perth Hills Discovery Centre are open to the public, so supervision of students is required at all times.

Nearer to Nature Schools program



Nearer to Nature
Schools

Nearer to Nature Schools programs run at the Perth Hills Discovery Centre along with other sites around the Perth metropolitan and Southwest regions. The programs offer schools, teachers, students and their communities a variety of educational programs and resources designed to foster awareness, appreciation and understanding of the natural environment and traditional Aboriginal culture. See our schools programs online by searching *Nearer to Nature Schools - Curriculum-linked school incursions, excursions and professional development*.

[Nearer to Nature Schools | Department of Biodiversity, Conservation and Attractions](#)



Nearer to Nature

Supervision strategies

Each school group is allocated a *Nearer to Nature* education officer for the duration of the excursion. The school is required to bring the number of adult supervisors suitable for the age group of their students. Full details are provided in the confirmation email. On arrival at the centre, a *Nearer to Nature* officer will greet the students and outline the program and the 'housekeeping' rules for the day. These include safety measures and defining boundaries for students.

Assessing the environment

Nearer to Nature venues offer excursion activities for school groups. Activities take place both indoors and outdoors, and along tracks in the forest. Teachers can assess the centres prior to an excursion by contacting *Nearer to Nature* for a tour of the facilities and areas used for activities.

Assessing students' capacity

The *Nearer to Nature Schools* excursion activities are suitable for students of all ages. The activities have been designed to suit the different developmental stages of young people. Our advertising material indicates the appropriate age for each of the excursions/activities offered. There is wheelchair access to and around most venues and limited access along some of the forest tracks.

Teachers should inform the *Nearer to Nature* officer of any students with special needs or medical conditions, preferably before arrival so that officers can adapt programs and methods of delivery accordingly.

Communication strategies (5)

The school will be advised before a group departs for the excursion if the weather conditions change suddenly and are unsuitable for the excursion e.g. very strong winds, a fierce storm or very hot conditions. Where possible, our staff will arrange for an alternative day for your school to attend the booked program. 2 way radios are carried by *Nearer to Nature* Leaders from the Perth Hills Discovery Centre for all activities. Mobile telephones are carried by *Nearer to Nature* Leaders at other venues at all times.



Nearer to Nature

Duty of care

The role of a *Nearer to Nature* education leader is to facilitate the student's activities. **School staff, however, have overall duty of care of their students at all times.** Please ensure that your students are identifiable with uniform if possible.

Transport and busses onsite

It is **strongly recommended** that you leave a vehicle on site so that in the event of an emergency you can evacuate your group at any time.

Nearer to Nature Community program

This program provides fun, interactive, nature-based activities for groups, families and individuals who are keen to enhance their enjoyment, knowledge and interest in the natural environment within the tranquillity of the forest. See our programs online by searching *Explore Parks WA – Nearer to Nature: activities for the community*

□ Copy of the commercial operator's permit (if applicable).

- Not applicable

□ Copies of any additional permits required by statutory authorities and land owners (if applicable).

- Not applicable

□ Copies of a Working with Children Check for any employee who will engage with the students. Volunteers assisting an external provider who are exempt from having a Working with Children Check are requested to complete Appendix C: Confidential Declaration Form in the Visitors and Intruders on Public Schools Premises Policy.

- Nearer to Nature staff's WWCC are available for viewing at the time of your booking confirmation via email, these are NOT Publicly available.
- Appendix C: Confidential Declaration Form for volunteers without WWCC on site:



Nearer to Nature

- We have voluntary [Camp Hosts](#) who volunteer their time to maintain our campground.
- They are usually identifiable by their bright blue Camp host t-shirt – see image below.
- The Perth Hills Discovery Centre has many Camp Hosts stay on site during the year.
- Most Camp Hosts do not regularly interact with children, however we ask them to fill in the Appendix C: Confidential Declaration Form.
- We also occasionally have work experience students or office volunteers on site.
- Volunteers are irregular, so it's not possible to include this information in this package.
- The forms for any volunteers without a WWCC on our site at the time of your activity are available at the office on site if requested.



Volunteer Camp Hosts wearing identifiable Parks and Wildlife Volunteer t-shirts



Nearer to Nature

□ **Copy of current general liability insurance (\$20 million cover minimum)**

- DBCA's General Liability is \$800 million, see our certificate of currency below.

CERTIFICATE OF CURRENCY



This Certificate is issued for information purposes only and does not confer any rights upon the Certificate holder and does not amend, extend or alter the coverage provided by the Cover detailed below.

Public Authority: Department of Biodiversity Conservation and Attractions

Cover Number: R/207344

Cover: General Liability (including Products Liability).

Situation of Risk: Worldwide

Covering: The legal liability of the Public Authority in respect of claims for compensation resulting from an occurrence.

Limit of Liability: \$800 million any one occurrence.

Excess: Nil

Expiry Date: 30 June 2026

Conditions: Subject to the RiskCover Certificate of Cover, Cover Document and Fund Guidelines.

This Cover has been effected with RiskCover (managed by the Insurance Commission of Western Australia).

Date Issued: 27 May 2025





Nearer to Nature

□ **Copy of professional liability insurance (\$5 million cover minimum)**

- DBCA's Professional Liability is \$300 million, see certificate of currency below.

CERTIFICATE OF CURRENCY

RiskCover

This Certificate is issued for information purposes only and does not confer any rights upon the Certificate holder and does not amend, extend or alter the coverage provided by the Cover detailed below.

Public Authority:	Department of Biodiversity Conservation and Attractions
Cover Number:	R/207344
Cover:	Professional Liability
Situation of Risk:	Worldwide
Covering:	The legal liability of the Public Authority for claims made and notified to RiskCover during the Period of Cover for errors or omissions in the rendering of professional advice or services.
Limit of Liability:	\$285 million any one claim.
Excess:	Nil
Expiry Date:	30 June 2026
Conditions:	Subject to the RiskCover Certificate of Cover, Cover Document and Fund Guidelines.

This Cover has been effected with RiskCover (managed by the Insurance Commission of Western Australia).

Date Issued: 27 May 2025





Nearer to Nature

- **Copy of the external provider's risk management plan.**

NEARER TO NATURE'S EXCURSION RISK PLAN

RISK MANAGEMENT ORGANISATION AND KEY PERSONNEL

CONTACT	DETAILS	PHONE NUMBERS
N2N education managers For school and community programs	Department of Biodiversity, Conservation and Attractions – Nearer to Nature	Education Programs manager: Marnie Giroud: 0417 937 986 N2N Schools Coordinators: Michelle Sharp & Rodney McGregor: 0404 819 175 N2N Office: (08) 9295 2244 N2N Community Programs Coordinator: Emma Schoknecht
Teacher In Charge		
Police / Ambulance For life threatening emergencies	000 (Emergency) 131 444 (Police Main line) 9290 1900 (Mundaring Police) 7250 Great Eastern Highway MUNDARING WA 6073 The Mundaring Police Station operates 7 days per week. If the station is locked then a telephone button outside the front door will connect you to officers at the Midland Police call taking centre who will pass on any tasks to the patrolling vehicles by police radio or mobile phone. (Bailup, Beechina, Chidlow, Gidgegannup, Glen Forrest, Gorrie, Hovea, Mahogany Creek, Malmalling, Mount Helena, Mundaring, Parkerville, Sawyers Valley, Stoneville, The Lakes, Wooroloo).	
DBCA Campground emergencies (non life threatening) after hours	DBCA Perth Hills (Mundaring) District Office (including Perth Hills District Duty Officer - DO) 275 Allen Road, Mundaring	92906100



Nearer to Nature

First Aid on site: Nearer to Nature (N2N) education	<ul style="list-style-type: none"> N2N leader with Senior First Aid will be on site. N2N to confirm morning of excursion which teachers have First Aid as this is the Teacher's Responsibility (as per Duty of Care information on page). 	<ul style="list-style-type: none"> (08) 9295 2244 A first aid station and kit will be located at meeting point and N2N officer's carry basic first aid kits during the activity. It is always the responsibility of the Teacher In Charge to administer first aid if required. N2N leaders may assist the Teacher In Charge if required.
Hospital St John of God Midland	1 Clayton Street, Midland 6056	9462 4000 Email: info.midland@sjog.org.au (non urgent requests)

VENUE – PERTH HILLS DISCOVERY CENTRE

The following Risk Management Plan has been compiled to address the risks involved with conducting excursions at Perth Hills Discovery Centre.

This Risk Review examines areas of risk associated with the general operation of excursions and programs developed and run by Nearer to Nature at this site.

This plan is to be considered as developmental and will be revised and expanded as required.

AIM

The aim of this plan is to document the process whereby **RISKS** are:

- IDENTIFIED**
What, why and how risks arise as a basis for further analysis



Nearer to Nature

- **ANALYSED**
In terms of likelihood and consequence
- **PRIORITISED**
Rank risks to identify management priorities
- **TREATED**
Through preventative and/or response measures involving:
 - Communication
 - Administrative
 - Structural
 - Training
- **MONITORED**
Establish a system to monitor and review the performance of the process and changes which might affect it.

OBJECTIVES

The objectives of the Risk Management Plan are to:

- Anticipate possible risks within the excursion
- Provide an effective and efficient prevention, identification and response to emergencies
- Supply relevant on-site information to Emergency Services
- Manage the orderly and timely evacuation if required of all attendees
- Establish and maintain a close working relationship with all relevant Emergency Services
- Develop specific management strategies for particular types of hazards

POSITION RESPONSIBILITIES WHEN RISK EVENTS OCCUR

DBCA Nearer to Nature Education leader	<ul style="list-style-type: none"> • Liaise with teachers and DBCA Nearer to Nature Duty Officer (DO), located onsite at Perth Hills Discovery Centre • Assess the situation and determine priorities • Activate the relevant emergency plan as requested by The Duty Officer • Liaise with external Emergency Services if required
-----------------------------------------------	-------------------------------------------------------------------------------------------------------------------------------------------------------------------------------------------------------------------------------------------------------------------------------------------------------------------------------------------------------------------------------



Nearer to Nature

- Provide on-going site information for participating agencies as required
- Inform DBCA managers of situation – Duty Officer at PHDC and Mundaring District

Nearer to Nature Duty Officer (DO)

- A Nearer to Nature staff member will be the designated Nearer to Nature Duty Officer on any given day. Their role will be to coordinate any safety or emergency response procedures.
- Liaise with the N2N Education Leaders if an emergency arises.
- Liaise with DBCA Perth Hills District Duty Officer, Teacher-In-Charge and/ or other emergency services personnel

Teacher

- Teacher In Charge has Duty of care for students in their charge.
- Follow DoE policies, emergency response plans and flowcharts.
- Assist the DBCA education leader in the event of an emergency.
- Assume control of students and other adults and direct them in the appropriate actions under the education officer's instructions.
- Report situation updates to the DBCA N2N leader as required.
- Teacher to liaise with school and evacuate their group if required.

RISK REVIEW

Risks are evaluated on a two-dimensional matrix using a qualitative rating of the likelihood and the scale of the possible consequence. This form of evaluation provides a graphic representation of the risk is or where the individual risk lies within a group of risks. Each risk has been rated according to the Likelihood and Consequences detailed below as based on the [Department of Education's Recreation and Outdoor Education for Public Schools Procedures – Risk Management Plan \(version 2.5, 2021, updated May 2024\)](#)

LIKELIHOOD:

1	Almost certain	The event will occur in most circumstances
2	Likely	High probability of occurring
3	Possible	May occur at some point in time
4	Unlikely	Unlikely to occur but could happen.
5	Rare	Occurs infrequently.



Nearer to Nature

CONSEQUENCE (for health and safety):

A	Insignificant	No injuries with no impact on activity. No treatment required.
B	Minor	Basic first aid treatment required (onsite), limited impact on activity. Minor injury requiring First Aid treatment (e.g. minor cuts, bruises, bumps).
C	Moderate	Medical treatment required with disruption or delays to activity. Injury requiring medical treatment or lost time.
D	Major	Serious injury requiring specialist medical treatment or hospitalisation. Major delay or suspension of activity is likely to occur.
E	Critical	Permanent or serious injuries sustained. Activity is immediately suspended

MAJOR SOURCES OF EVENT RISK

This Risk Review looks at the following major sources of operational risk:

- Environmental risk – hailstorms, heat.
- Public health and safety – including crowd management, pedestrian and traffic movement, injury, assault, fire, OHS breaches.
- Asset loss – theft, damage.

TREATMENT OPTIONS/PRINCIPLES

- The review outlines the treatment best suited for the risks outlined. Below is a breakdown of the options:
 - Accept Risk = Not commercially treatable.
 - Avoid Risk = Do not carry out the activity.



Nearer to Nature

- Transfer Risk= Contract risk area to an expert service provider.
- Mitigate = Insure via broker, check coverage and risk.
- Treat = Take some specialised action to reduce risk

RISK IDENTIFICATION

Attached you will find the risk identification charts which outline the risks involved in various aspects of event management. Subjects covered include:

- Human Resource Management
- Natural & Man-made disasters
- Operational and Crowd Safety
- Health
- Crimes and Misdemeanours



Nearer to Nature

RISK MATRIX

#	Perth Hills Discovery Centre Excursion Risks	Likelihood 1 to 5	Consequence A to E	Inherent Risk (low, moderate, high, extreme) Before Treatment	Residual Risk (low, moderate, high, extreme) After Treatment	Notes of Treatment Principles
	Risk Source/Types					
1	Fire	5	E	H	L	Accept Risk
2	Lost Child	4	E	H	M	Mitigate/Transfer / Treat
3	Lost Adult	4	E	H	M	Mitigate/Transfer / Treat
4	Criminal activity / violent /threatening	5	E	H	M	Mitigate/Transfer/Treat
5	Criminal activity / theft	5	D	M	L	Accept Risk
6	Animal bite/attack	4	E	H	M	Mitigate/Transfer / Treat
7	Slip/falls	3	C	M	L	Accept Risk
8	Falling tree limbs	5	E	H	L	Accept Risk
9	Mosquito/tick bites	3	C	M	L	Accept Risk
10	Storm	5	C	M	L	Accept Risk
11	Sunburn and Dehydration	3	C	M	L	Mitigate/Transfer / Treat

CONSEQUENCE

LIKELIHOOD	A (Insignificant)	B (Minor)	C (Moderate)	D (Major)	E (Severe)
1 Almost certain	Moderate	High	High	Extreme	Extreme
2 Likely	Moderate	Moderate	High	High	Extreme
3 Possible	Low	Moderate	Moderate	High	Extreme
4 Unlikely	Low	Moderate	Moderate	Moderate	High
5 Rare	Low	Low	Moderate	Moderate	High



Nearer to Nature

Please find below a list of controls and actions required for the most relevant risks associated with excursions at Perth Hills Discovery Centre.

Risk	Level of Risk	Controls	Level of Risk
Fire	H	<ul style="list-style-type: none"> Emergency evacuation plan (Appendix 	L
Lost Child	H	<ul style="list-style-type: none"> Teacher/parent supervision and responsibility 	M
Lost Adult	H	<ul style="list-style-type: none"> Site map distributed to adults 	M
Criminal activity / violent /threatening	H	<ul style="list-style-type: none"> Adult supervision and responsibility Students informed to be aware of public and inform adult 	M
Criminal activity / theft	M	<ul style="list-style-type: none"> Adult and student supervision and responsibility of personal belongings 	L
Animal bite/attack	H	<ul style="list-style-type: none"> First Aid Post Senior First Aid Officers on site Student informed to stay away from animals where possible 	M
Slip/falls	M	<ul style="list-style-type: none"> First Aid Post Senior First Aid Officers on site Site walked to identify potential hazards 	L
Falling tree limbs	H	<ul style="list-style-type: none"> Tree hazards assessed by qualified arborist every two years First Aid Post Senior Aid Officers on site Site walked prior to activity to identify any tree risks 	L
Mosquito / tick bites	M	<ul style="list-style-type: none"> Mosquito repellant / spray to treat tick bites 	L
Storm	M	<ul style="list-style-type: none"> If storm occurs excursion will be cancelled 	L
Sunburn and Dehydration	M	<ul style="list-style-type: none"> Water and sunscreen available onsite Senior First Aid Officers on site 	L



Nearer to Nature

RISK ACTION PLANS

Description	Pre-excursion safety warning
Priority	Significant
<ul style="list-style-type: none"> Teachers and parents to be advised they are responsible for their children/students during their visit. In an emergency the education leader will blow their whistle and everyone must meet at a suitable muster point, advised by the N2N Duty Officer (DO) Point out location of muster points. Advise teachers of the risk of child wandering off. First Aid Officer and first aid station will be identified to all present. 	

Description	Fire
Priority	Significant
Summary of response and impact	Duty officer, Education Leader and teacher to raise response as appropriate
Proposed actions	<ul style="list-style-type: none"> Adults and students to be aware of their surroundings and follow directions of Duty Officers (both District and N2N) N2N Education officer and teachers to take initial action if an incident was to occur, and then contact the DBCA Duty Officer (0290 6100) and/or DFES if required.
Expected level of risk after controls put in place	Moderate

Description	Lost Child / Adult
Priority	Significant
Summary of response and impact	Education leader and teacher to raise response as appropriate
Proposed actions	<ul style="list-style-type: none"> Regularly check all participants are present After first five minutes of a person being noted as lost, emergency whistles are blown by N2N Education leader and all adults notified.



Nearer to Nature

	<ul style="list-style-type: none"> Education leader and teacher to take initial action if an incident was to occur, and then contact the Police if required.
Expected level of risk after controls put in place	Moderate

Description	Criminal activity / violent / threatening
Priority	Significant
Summary of response and impact	N2N Education leader and teacher to raise response as appropriate
Proposed actions	<ul style="list-style-type: none"> Adults to regularly check amenities (toilet block) and patrol the area. Education leader and teachers to take initial action if an incident was to occur, and then contact the Police if required.
Expected level of risk after controls put in place	Moderate

Description	Snake Bite / Animal Attack
Priority	Significant
Summary of response and impact	First Aid Officers to assist
Proposed actions	<ul style="list-style-type: none"> Adults and students to be aware of their surroundings and the presence of animals at location. N2N Education leader and teachers to assess response ranging from monitoring patient and supervising others, to calling 000.
Expected level of risk after controls put in place	Moderate

Description	Slip/Falls
Priority	Significant
Summary of response and impact	First Aid Officers to assist
Proposed actions	<ul style="list-style-type: none"> Adults and students to be aware of their surroundings, N2N education leader to conduct safety briefing at start of activity.



Nearer to Nature

	<ul style="list-style-type: none"> N2N Education leader and teachers to assess response - monitor patient and supervising others, to calling 000.
Expected level of risk after controls put in place	Moderate

Description	Falling Tree Limbs
Priority	Significant
Summary of response and impact	Education leader and teacher to raise response as appropriate
Proposed actions	<ul style="list-style-type: none"> Education Officer and N2N education leader to walk tracks and survey areas for dead or broken branches that are a fall risk. Every 2 years arborists conduct site assessments and remove potentially dangerous branches.
Expected level of risk after controls put in place	Moderate

Description	Storm/Severe Weather Warning
Priority	Significant
Summary of response and impact	Education Officer to contact schools regarding emergency/weather warnings
Proposed actions	<ul style="list-style-type: none"> When severe weather warnings are present, N2N Education or Bookings Officer contacts the school to cancel excursion When extreme and/or catastrophic Fire danger Ratings are forecast, N2N Education or Bookings Officer contacts the school to post-pone/cancel excursion
Expected level of risk after controls put in place	Moderate

Description	Sunburn / Dehydration
Priority	Significant
Summary of response and impact	Education Leader and teacher to raise response as appropriate
Proposed actions	<ul style="list-style-type: none"> Sunscreen and water fountains are located on-site. Teachers are advised to inform students about bringing their water bottle.



Nearer to Nature

Expected level of risk after controls put in place	Moderate
-------------------------------------------------------	----------

□ **Copy of the external provider's emergency response plan.**

Perth Hills Discovery Centre Emergency Evacuation Plan

Our *Nearer to Nature* officers, in collaboration with other delegated Departmental staff are responsible for implementing the plan. If an evacuation is required, all school staff, students and assistants must take directions from our *Nearer to Nature* officers and leaders. The *Nearer to Nature* staff have records all activities taking place. Student and adult numbers are recorded at the Centre prior to departure for activities in the forest.

Procedure:

1. **Emergency Signal:**

The Nearer to Nature Duty Officer (DO) uses a signal horn to make **3 long bursts** of an emergency signal via radio to all Nearer to Nature Education Leaders.

2. **Nearer to Nature Leader organises group:**

N2N Leaders blows their whistle 3 times to coordinate group and counts participants.

3. **Nearer to Nature Education Leader radios the Nearer to Nature Duty Officer (DO):**

N2N Education Leader relays participant numbers, group location and Muster Point with DO.



Nearer to Nature

4. **Nearer to Nature Leader starts moving the group** to the Muster Point identified by the Duty Officer.
 5. **Nearer to Nature Leader reports to the Duty Officer** who has signalled the evacuation (wearing a fluorescent vest and hard hat) relays that all are present/not present
 6. **Nearer to Nature Duty Officer addresses the Nearer to Nature Leaders and teachers and directs emergency evacuation** depending on the type and location of the threat.
- **Copy of the external provider's planning documents for each specific recreation or outdoor education activity that will be conducted.**
- A timetable with brief description of the activity booked are available and included with the booking confirmation via emails from the Nearer to Nature Bookings officer via our n2n@dbca.wa.gov.au email.at the time of confirmation
 - An activity description for each Nearer to Nature secondary school program in the Perth Metro can be found online here: [Parks and Wildlife Service WA Reservations](#)
 - An activity description for each Nearer to Nature primary school program in the Perth Metro can be found online here: [Parks and Wildlife Service WA Reservations](#)



Nearer to Nature



N2N's Nocturnal Fauna Monitoring Program – students learning how to set camera traps for fauna monitoring



Nearer to Nature

- Copy of emergency evacuation plans for the areas being used in this activity.



Nearer to Nature

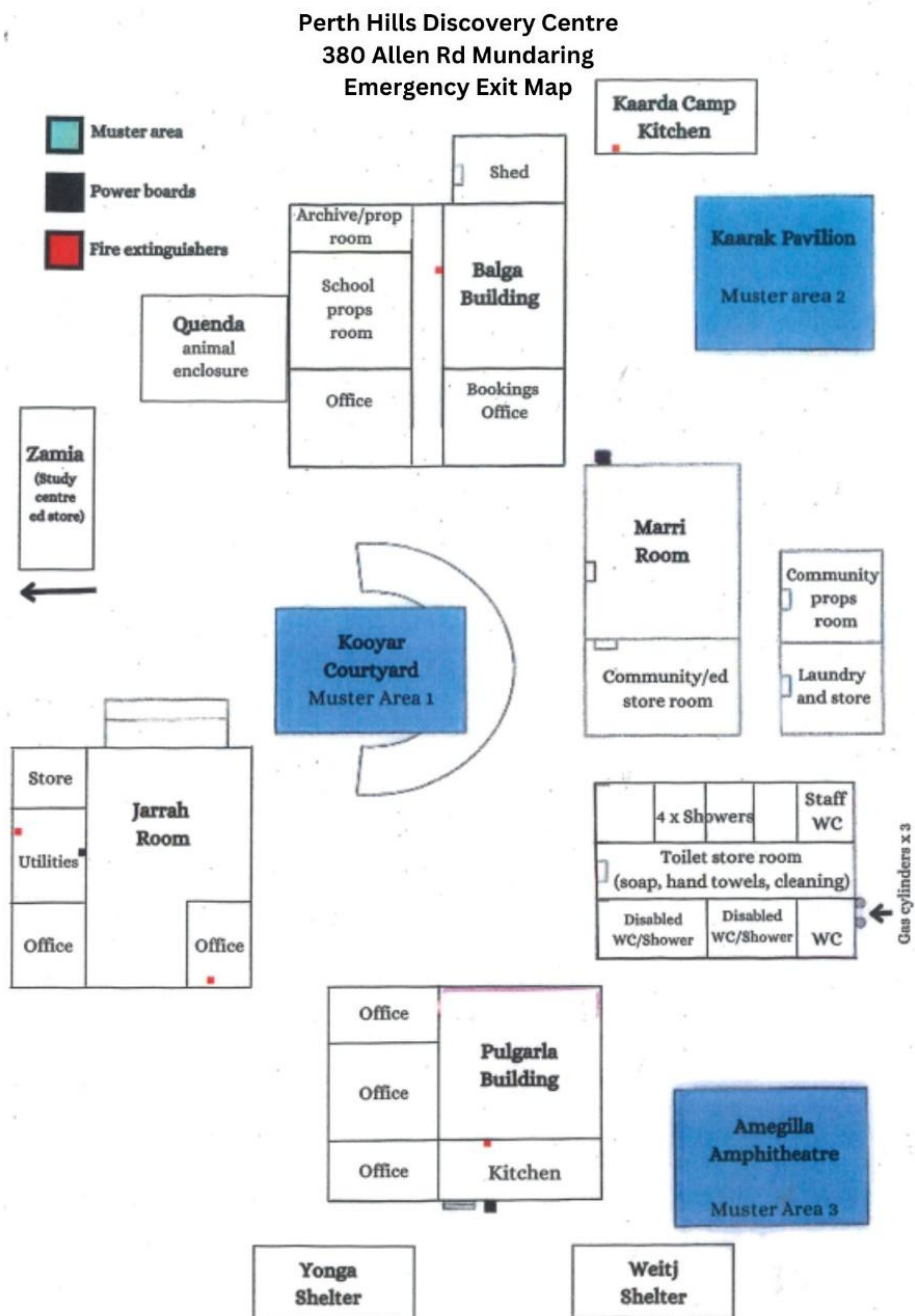



Nearer to Nature

Perth Hills Discovery Centre (PHDC) – venue information

The Perth Hills Discovery Centre is a meeting place, walk trail hub, campground and education facility where you can immerse yourself in the jarrah and marri forest close to Perth. The historic Mundaring Weir is a short drive, or half-hour walk south along the famous Bibbulmun Track, or you may like to hike the Bibbulmun Track north to the Ball Creek Hut for lunch.



Aerial view of Perth Hills Discovery Centre (PHDC) showing shelters, building, campground and parking locations.

- Please note that the vehicle access to the centre is via Allen Road.



Nearer to Nature

VENUE ACESSIBILITY

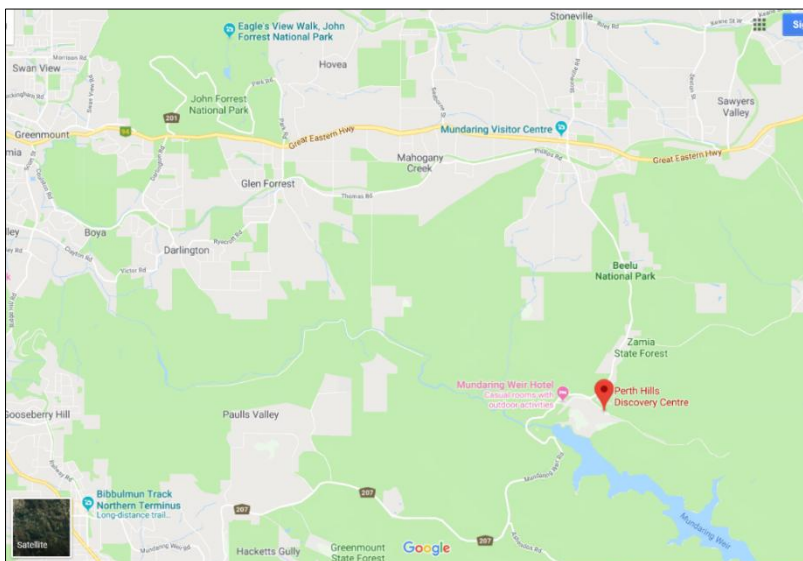

The PHDC is a bespoke all abilities centre providing accessible entry from the main carpark through a series of brick pathways and wooden decking and ramps into the centre buildings, some shelters, the campground and Beelu National park. Accessible toilets, shower and braille signs indicating toilet options are all part of the inclusive experience ensuring that everyone can get *Nearer to Nature*. Our team are committed to embracing diversity and inclusion. Please contact us ahead of time to discuss your group/students requirements and we will endeavour to customise the program to suit your needs.

Perth Hills Discovery Centre Address: 380 Allen Road, Mundaring 6073

Find us on [Google maps](#) or visit [Explore Parks WA](#)

Contact us: Phone - N2N programs information and bookings 9295 2244

Email - n2n@dbca.wa.gov.au



Nearer to Nature

Perth Hills Discovery Centre Campground



Perth Hills Discovery Centre
Beelu National Park

Campground Map

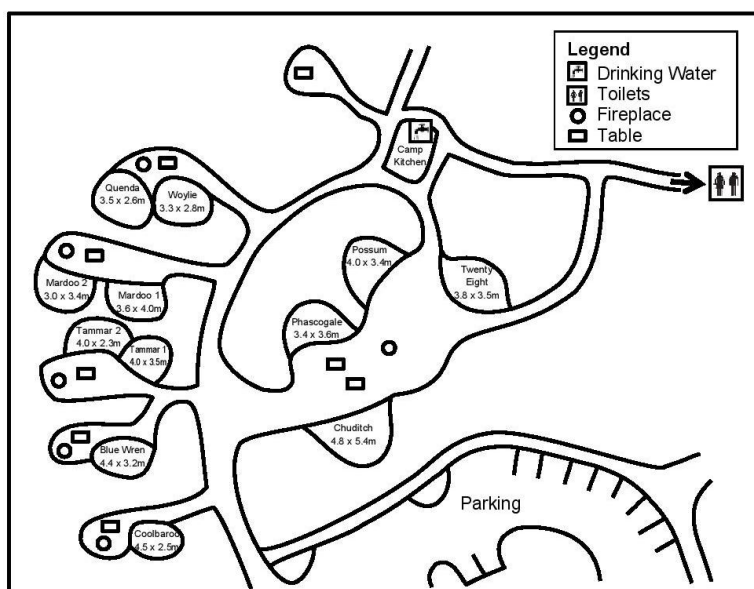

The Perth Hills Discovery Centre campground is located within Beelu National Park and 12 shady tent sites are available for hire. An undercover camp kitchen includes a fridge, kettle, microwave, power points and electric BBQs. The campgrounds are set aside for schools who wish to camp whilst participating in our Nearer to Nature programs during the week during term. Ask about this option when booking a program with our staff on n2n@dbca.wa.gov.au. Emergency contact information for the campground is on page 9.

IMPORTANT: Please note that DBCA officers are not present onsite after hours. The Teacher-In-charge (camp organiser) and school supervisory team have Duty of Care and are responsible for the health and safety of students at all times during your camp - as per Department of Education's Recreation and Outdoor Education Activities for Public Schools Procedures'.

****It is strongly recommended that your group keep vehicle/s onsite at all times to evacuate your entire group in the event of an emergency.**